



“ARCHITECTURE” THE SOUND OF FROZEN MUSIC

| AD PORTFOLIO | SNEHA JAMES | MASAP |

CURRICULUM VITAE

Name : Sneha James
Birth date : 27/02/1998
Address : 49/3H, Pearl Gardens
Perandur Bridge Road
Elamakkara

Home town : Ernakulam
State : Kerala
Nationality : India
Email : snehajames0055@gmail.com
Phone no. : 8921331839

INTERESTS



ACADEMICS

XTH : Champion Public School
Edappally - 96%
XII : Sacred Heart H.S.S.
Thevara - 90%

LANGUAGE SKILLS



SOFTWARES



KINDERGARTEN
S3

1



RESIDENCE
S4

2



CAMPUS DESIGN
S4

3



INTERIOR DESIGN
S4

4



LANDSCAPE
ARCHITECTURE
S5

5



BASIC DESIGN
S1 & S2

6



SKETCHES

7



EXTRAS

8



TROPHY
WORKS
S5

9



DOCUMENTATION
S3

10



'It all starts here so loop it around the nature'

Magic lives in curve not in angles. Each child is a magic. The reason behind the form

Curves enhances human pleasure and freedom of movement.

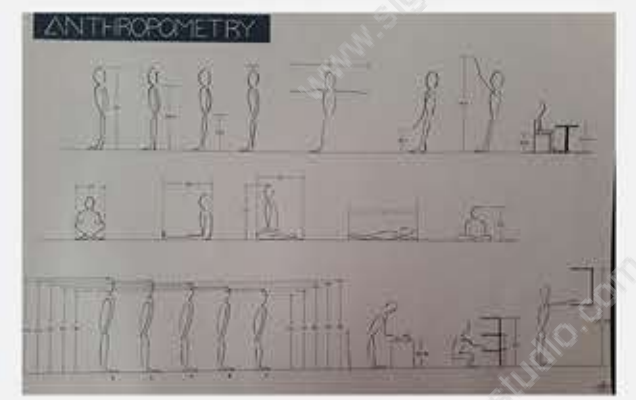
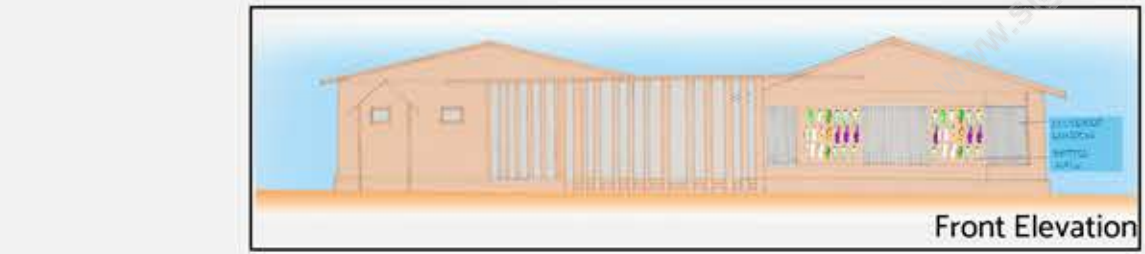
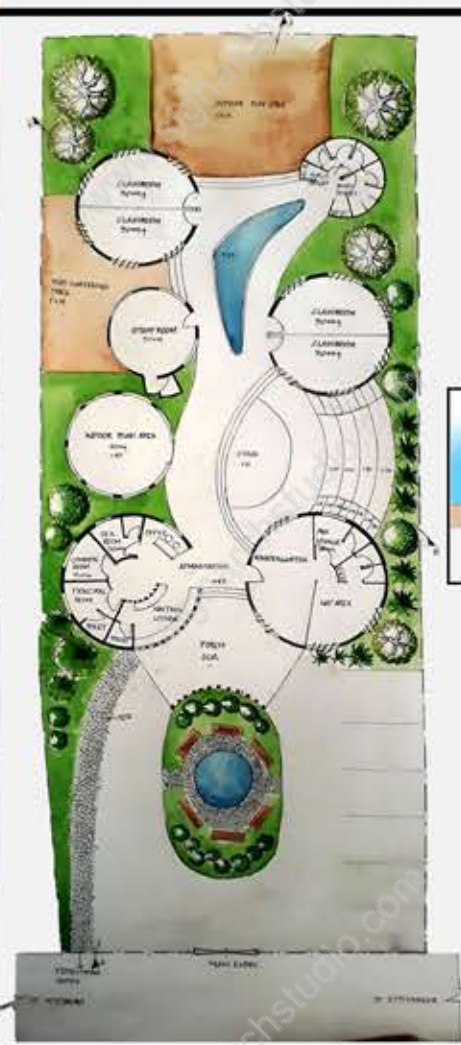
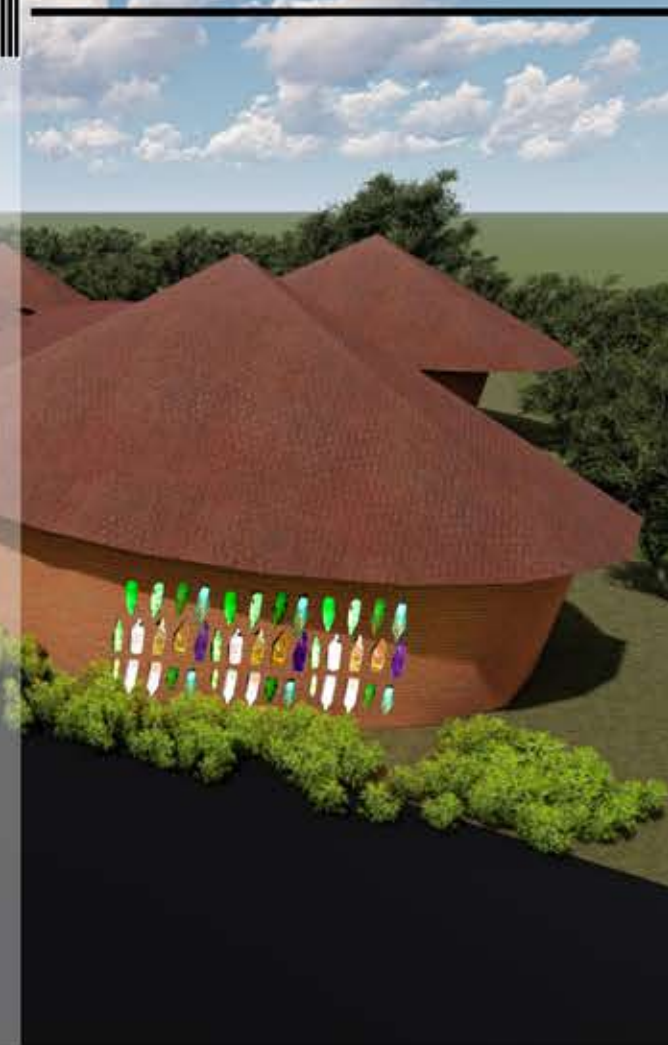

'The Music Villa'

The residence is designed for musician want an absolute blend of music with nature.

So the basic concept of the design was blending the rhythm of music with nature. Different recreational spaces are provided to enhance the freedom of thinking and variety.

A recording studio was an additional space required for the client



Ground floor plan

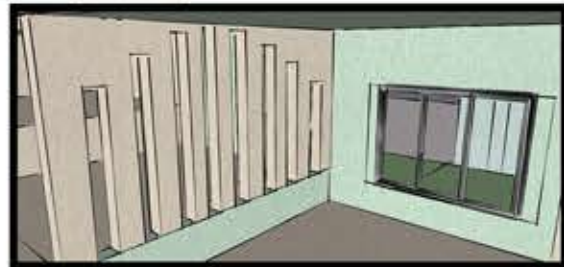
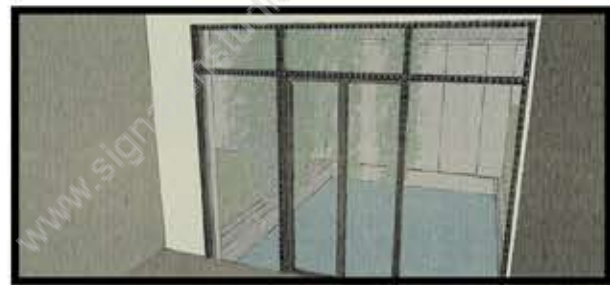

First floor plan

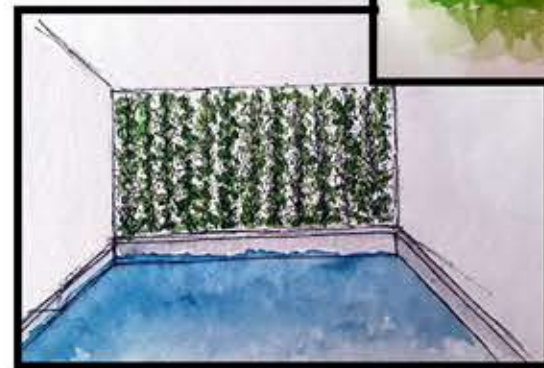
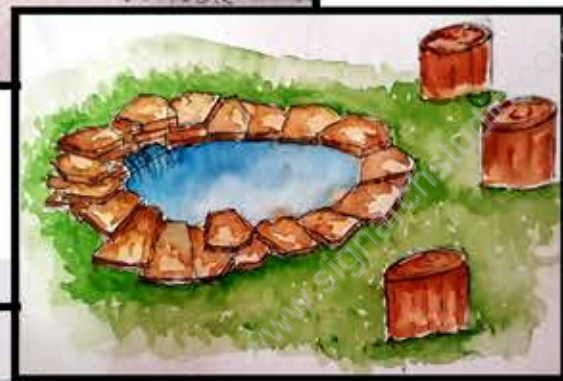

**'Breaking out linearity'
'Defragmenting the fragments'**

These were the two major concerns and concepts which lead my way while designing the campus. The campus is provided with various outdoor space to enhance the quality of thinking and learning. Green spaces are also included in the campus to bring the feel of outside inside.



- 1 SECURITY CABIN
- 2 FACULTY BLOCK
- 3 ADMINISTRATION
- 4 ACADEMIC BLOCK
- 5 AMPHITHEATRE
- 6 AUDITORIUM
- 7 WATER CASCADE WITH SEATING PLATFORMS
- 8 CAFETERIA
- 9 FACULTY HOUSING 2BHK
- 10 FACULTY HOUSING 1BHK
- 11 DISCUSSION CUBICLES
- 12 GYM



- 13 CANTEEN
- 14 KITCHEN
- 15 GIRLS HOSTEL
- 16 BOYS HOSTEL
- 17 FOOTBALL GROUND
- 18 BASKETBALL COURT
- 19 CENTRAL STORE AND REPOGRAPHY
- 20 RAINWATER HARVESTING POND
- 21 STP
- 22 SERVICE BLOCK
- 23 SEATING PLATFORMS

The feel of 'Nostalgic Frames'

The basic concept of choosing the color theme was to bring back the past 'A walk through the Past'. This was designed for a musician who loved memory of successful past.

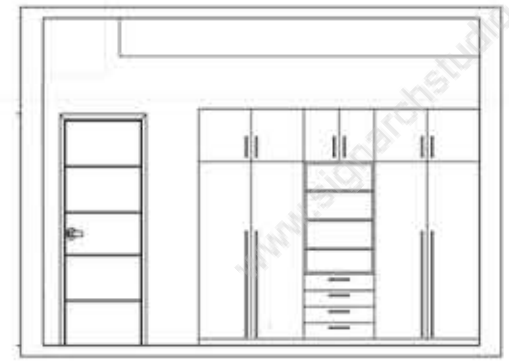
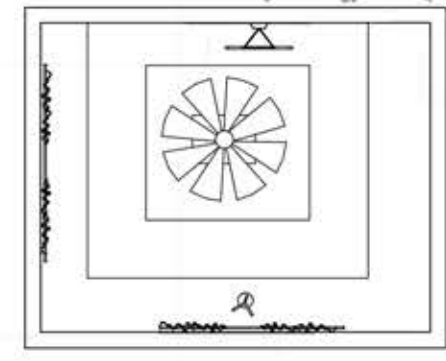
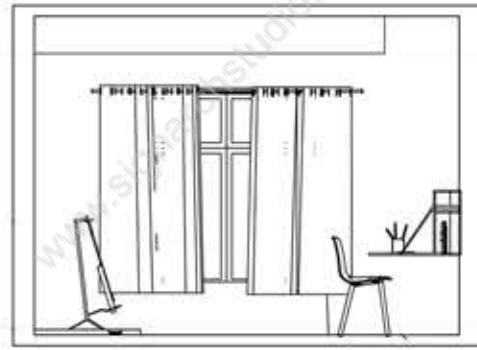
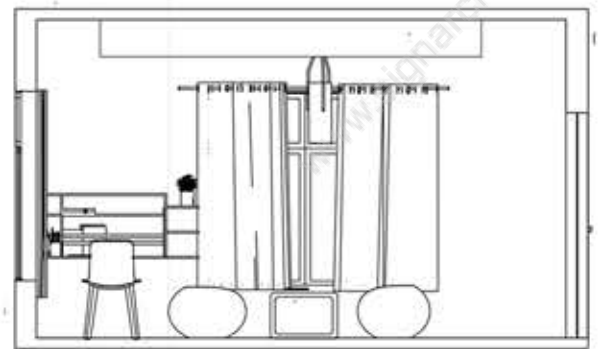
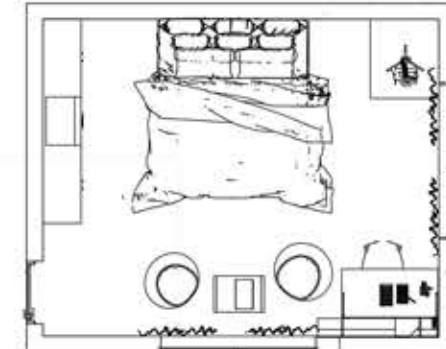
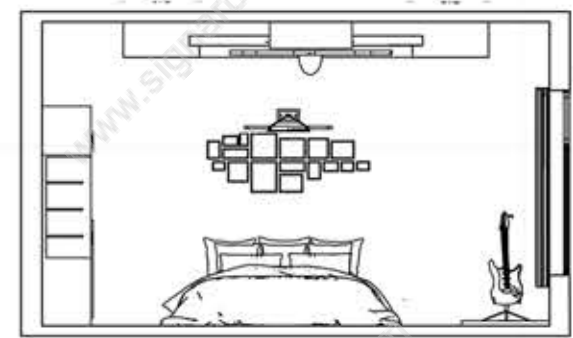

CONCEPT

Diffusion

Maximize the light output by diffusing it to all directions of the space, creating ambience for functions by avoiding glare

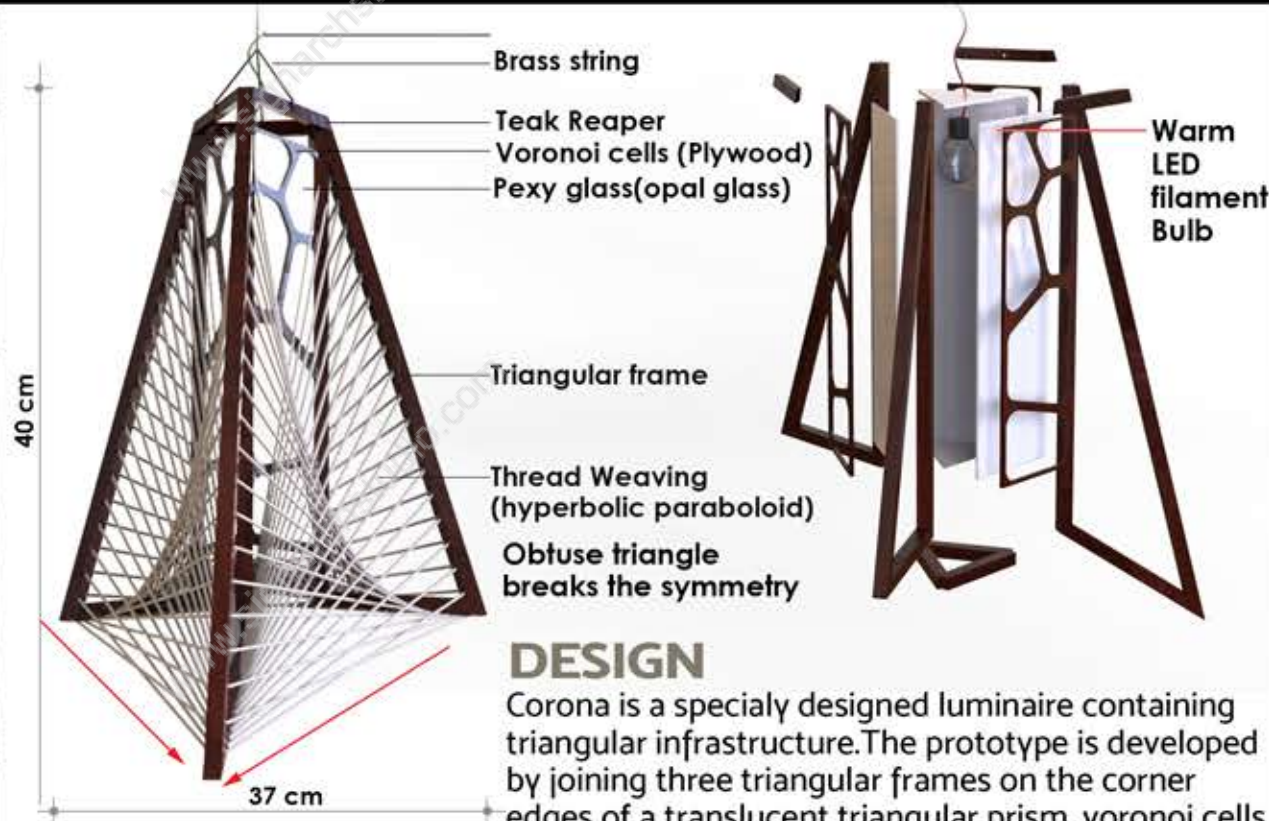

DESIGN

Corona is a specially designed luminaire containing triangular infrastructure. The prototype is developed by joining three triangular frames on the corner edges of a translucent triangular prism, voronoi cells overlap the prism, the thread pattern connecting base edge of frames and long edge of adjacent frames create hyperbolic paraboloids thread connects the 15 divisions of base edges and long edges of adjacent frames

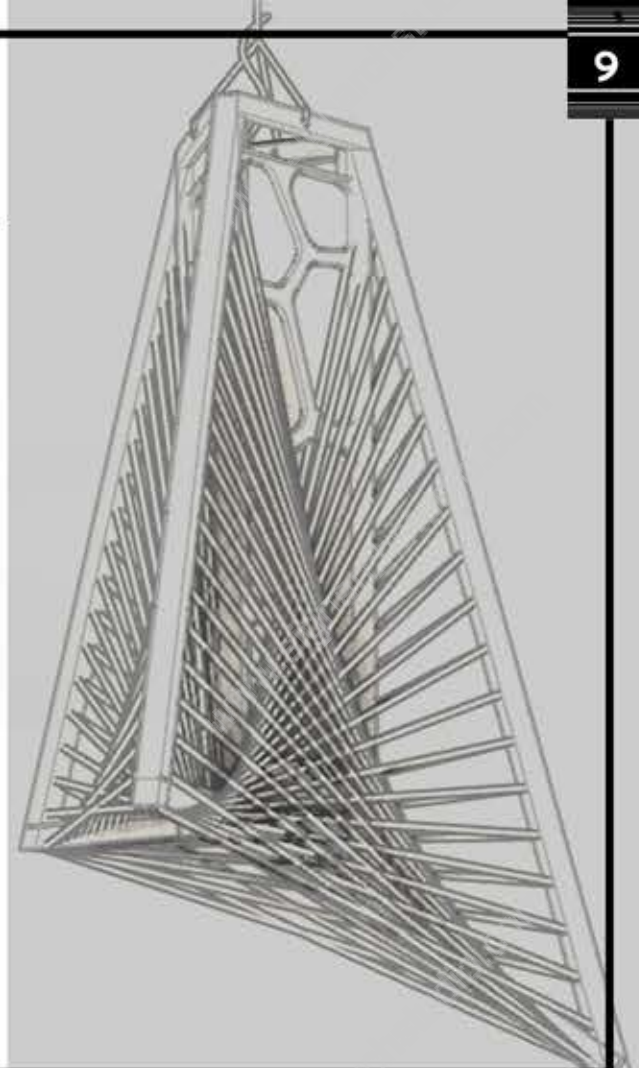

URBAN CHAIR DESIGN THE LOOP CHAIR

The chair has circular seating spaces of 45 cm diameter each. The chair is made of timber and can accommodate 4 people at a time. The central space is used for plantation.

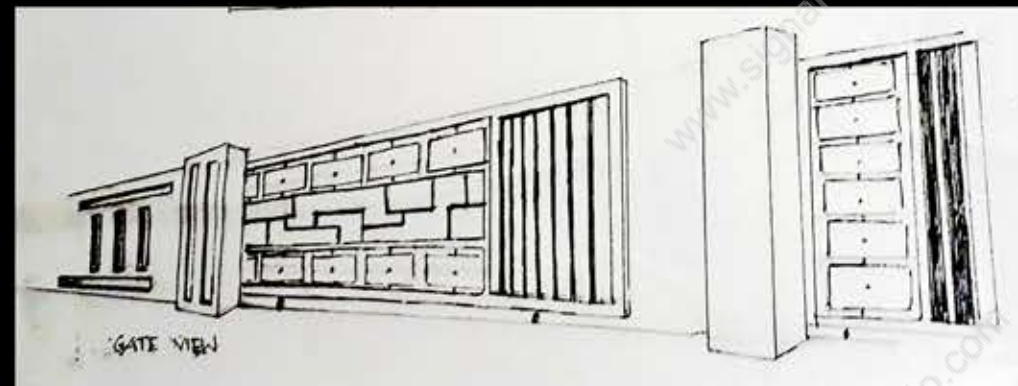
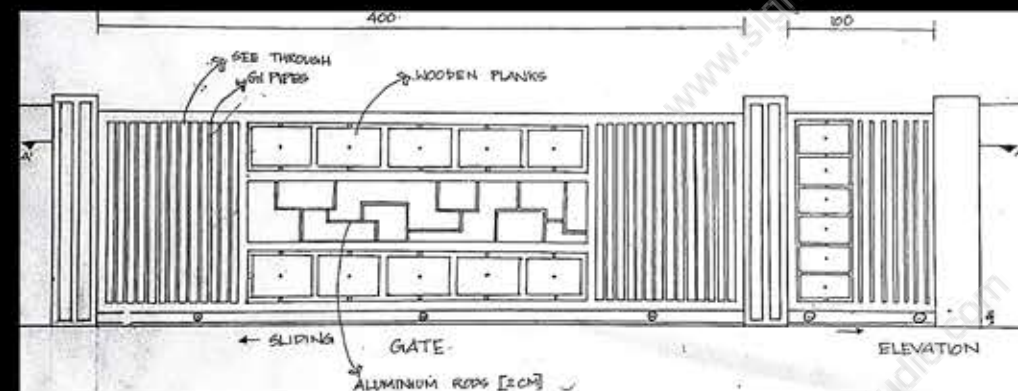
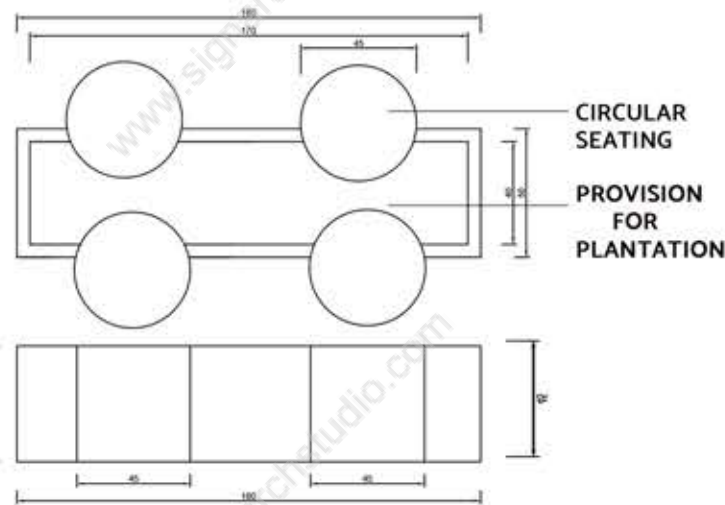

RESIDENCE GATE DESIGN

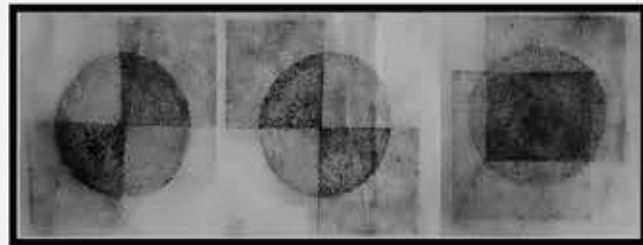
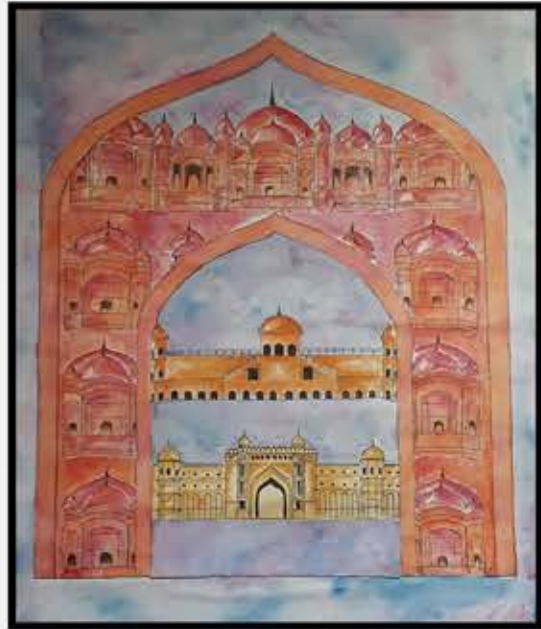
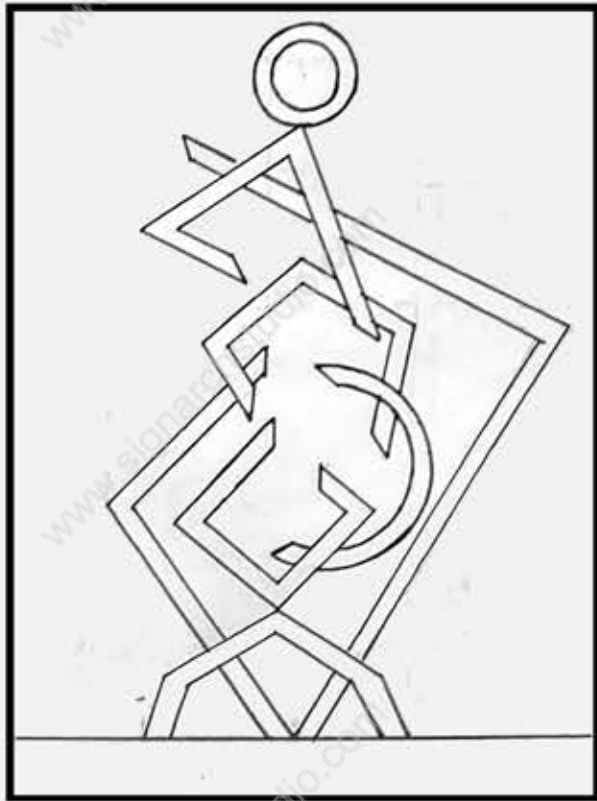

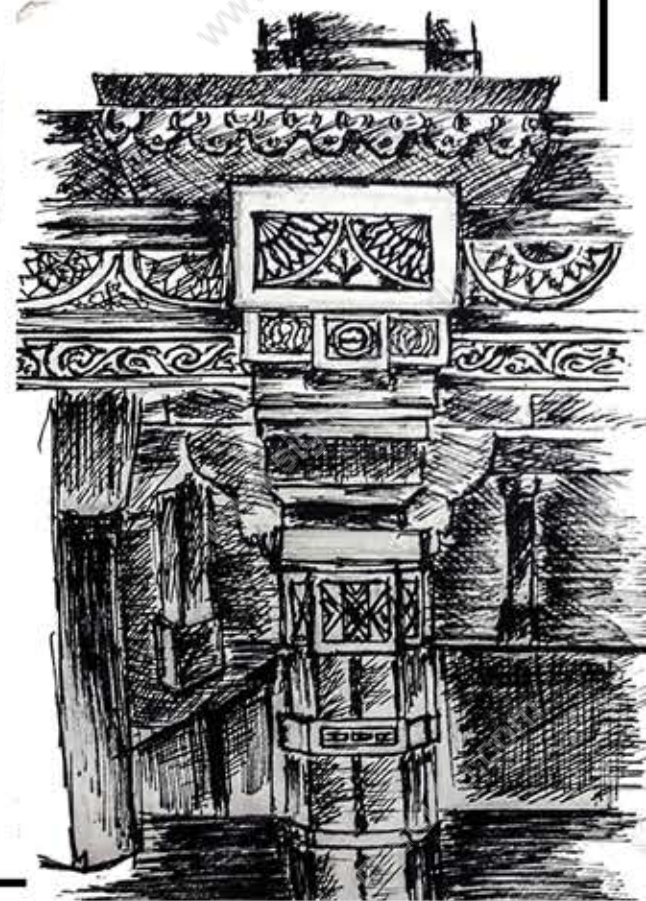
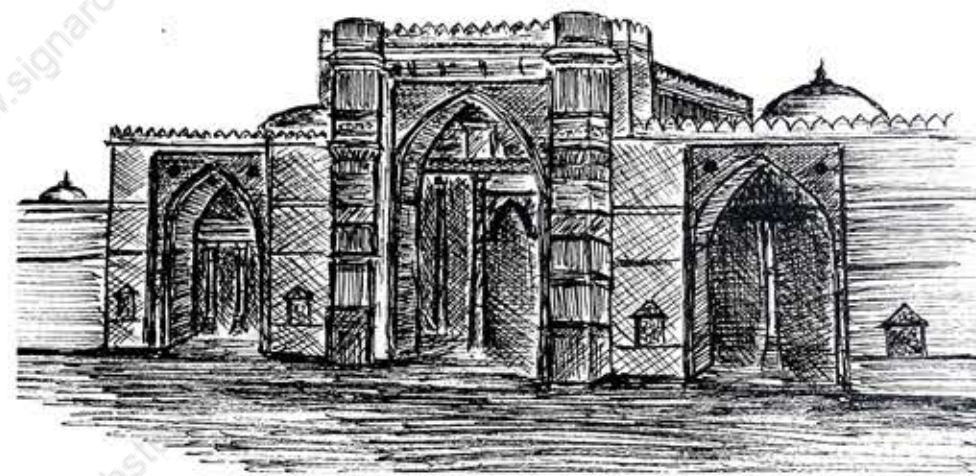
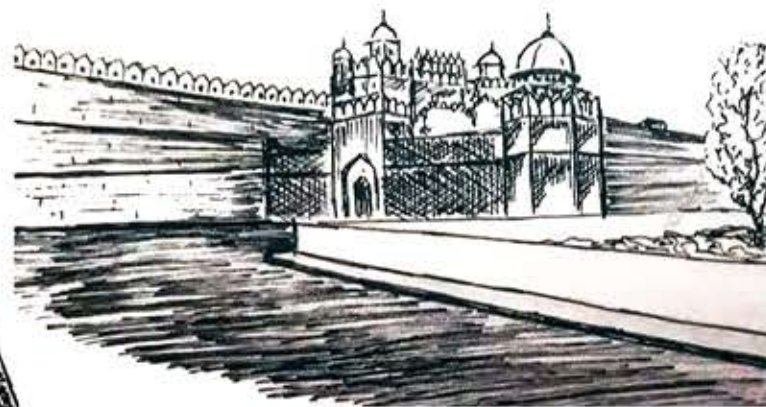
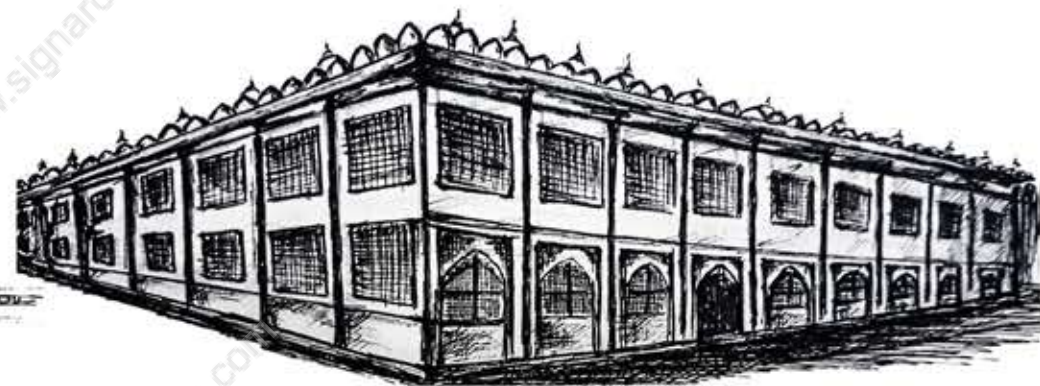
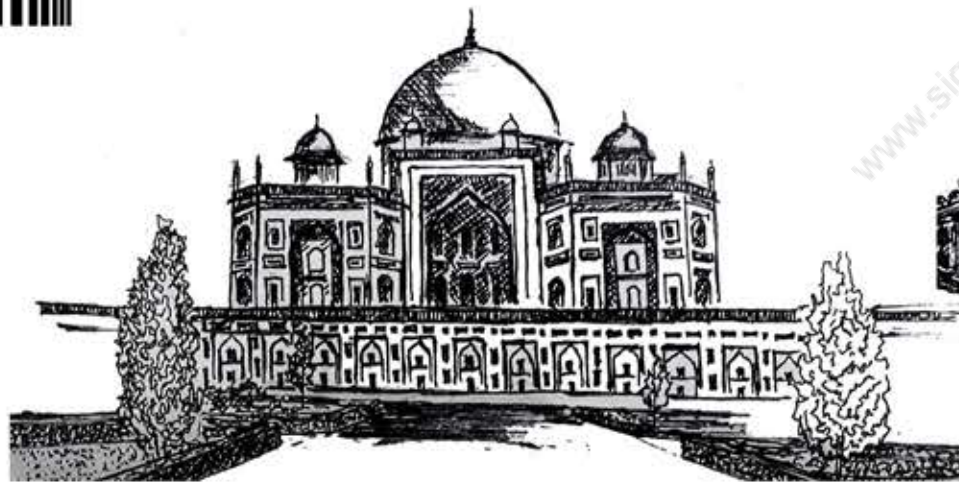
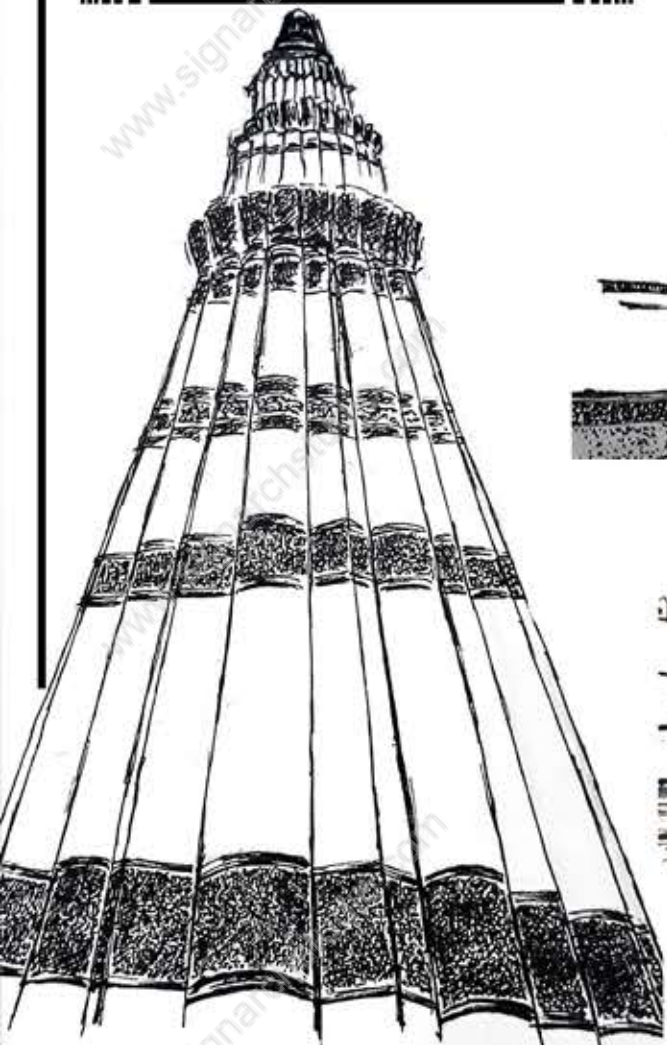



PHOTOGRAPHY

COVER PAGE
DESIGN

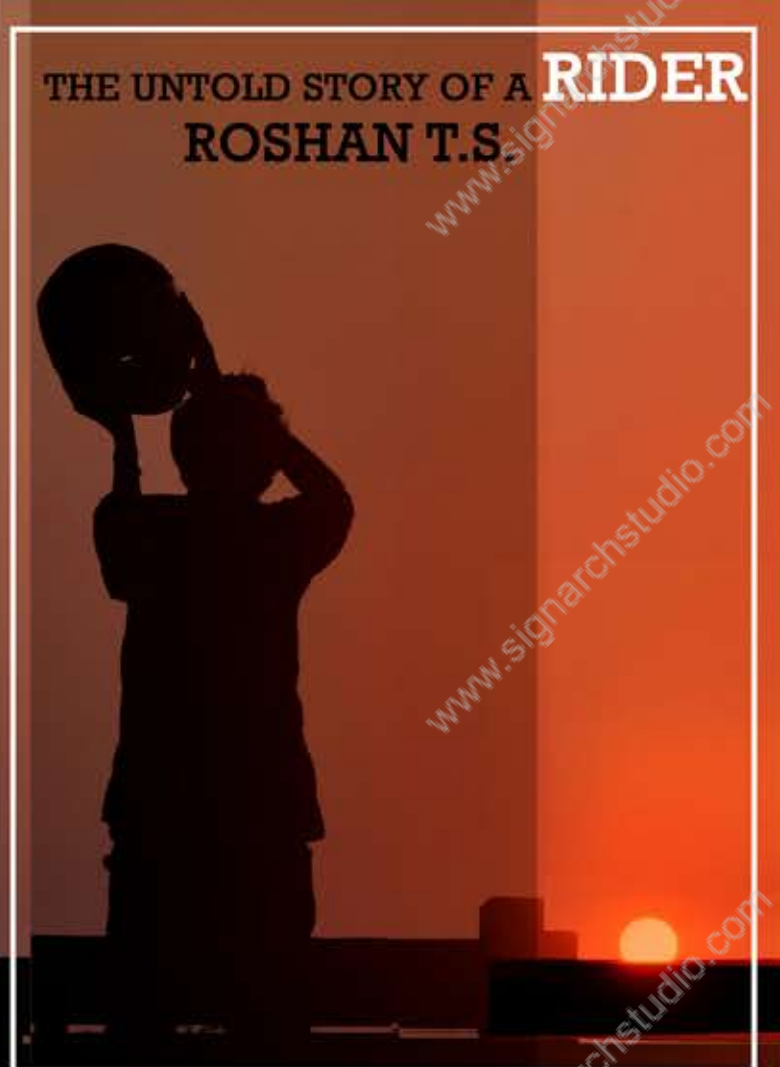

SNEHA JAMES

MARTH MARIAM CATHEDRAL IS THE CATHEDRAL OF THE CHALDEAN SYRIAN CHURCH OF INDIA. PART OF THE ASSYRIAN CHURCH OF THE EAST, IT IS LOCATED IN THRISSUR CITY IN THE STATE OF KERALA, AND IS THE CITY'S FIRST CHRISTIAN CHURCH.

THE CHURCH ESTABLISHED IN 1814 BY CHALDAYA SURIYANI (HALF CATHOLIC, HALF NESTORIAN) FACIION OF THE SYKO-MALABAR CATHOLIC CHURCH AND WAS ORIGINALLY KNOWN AS OUR LADY OF GLOUORS CHURCH, ABRAHAM KATHANAR OF PALAI WAS THE HEAD OF THE CHALDEAN SYRIAN FACIION IN 1814, WHOSE HEADQUARTERS WAS AT THRISSUR.



- 1789 THE SYKO MALABAR CHURCH, THEN KNOWN AS OUR LADY OF GLOUORS CHURCH, WAS ESTABLISHED BY CHALDAYA SURIYANI.
- 1790 THE CHURCH WAS RENAMED AS MARTH MARIAM CHURCH.
- 1790-1805 MOST OF THE CHURCH WAS DESTROYED BY TIPU SULTAN.
- 1794 AFTER THE DESTRUCTION OF THE CHURCH, THE CHURCH WAS REBUILT BY CHALDAYA SURIYANI.
- 1814 CHALDAYA SURIYANI WAS THE HEAD OF THE CHURCH AND HE MADE THE CHURCH HIS HEADQUARTERS.
- 1927 CONSTRUCTION OF THE CHURCH WAS COMPLETED BY JUBIN KATHANAR.
- 1929 THE CHURCH WAS RENAMED AS MARTH MARIAM CHURCH AND THE CHURCH WAS REBUILT BY CHALDAYA SURIYANI.
- 1968 THE CHURCH WAS RENAMED AS MARTH MARIAM CATHEDRAL.

SITE PLAN



MARTH MARIYAM CHURCH, ALSO KNOWN AS VALIYA PALLI IS ONE OF THE OLDEST CHALDEAN SYRIAN CHURCH IN THRISSUR. THE CHURCH WAS ESTABLISHED IN 1811 UNDER THE SURVEILLANCE OF RAMA VARMA KNOWN AS SHAKTHAN THAMPURAN.

IN 1789, THE CITY WAS ATTACKED BY TIPU SULTAN, AND THUS THE TOWN FACED ENORMOUS DESTRUCTION BOTH ECONOMICALLY AND FINANCIALLY, THEREBY, SHAKTHAN THAMPURAN DECIDED TO RENOVATE THE TOWN, AS PART OF THE RENOVATION, FORTIFICATIONS AROUND THE TOWN WERE ERECTED. HE MADE 52 CHRISTIAN FAMILIES SETTLE THERE, WITH AN INTENTION OF FOSTERING THE TRADE.

AS TRADE PROGRESSED ALONG WITH NEW MERCHANTS, THE PEOPLE REQUESTED THAMPURAN TO BUILD A CHURCH. THE KING PERCEIVED THE SIGNIFICANCE OF THE CHURCH AND THE RELIGIOUS NEEDS OF THE COMMUNITY HE BUILT THE CHURCH. AS IT WAS THE FIRST CHURCH TO BE CONSTRUCTED WITHIN THE LOCALITY, THEY DEPENDED ON NEARBY OLLUR CHURCH FOR BASIC PLANNING MEASUREMENTS. BY MISTAKELY THE INNER DIMENSIONS OF OLLUR CHURCH WAS TAKEN AS REFERENCE FOR OUTER DIMENSIONS OF THE NEW ONE. HENCE THE SPACE WAS CONFINED.

THE CHURCH CARRIED OUT FURTHER ADDITIONS, RENOVATIONS AND ALTERATIONS IN RECENT YEARS.

53 2016-2021

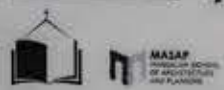

Kaldaya charitham
DOCUMENTATION OF MARTH MARIAM VALIYAPALLI COMPLEX THRISSUR

53 2016-2021



ALTAR
The altar is the central part of the church. It is a place where the priest reads the scriptures and performs the sacraments.



MAQRANA
The maqbara is a place where the dead are buried. It is a place of great sanctity and is usually located near the altar.



REMA
The rema is a small structure built on the walls which is used for the storage of the church's records.

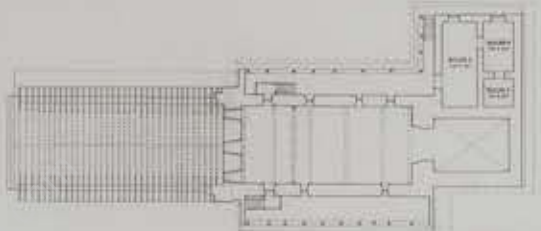

FIRST FLOOR PLAN

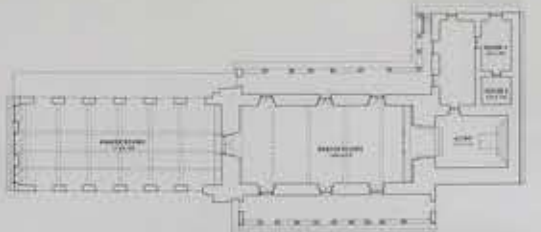

GROUND FLOOR PLAN



PULPIT
The pulpit is a raised platform where the priest reads the scriptures and preaches the word of God.



CHOIR LOFT
The choir loft is a raised platform where the choir sings the hymns and psalms.



PERPETUAL LAMP (KIDAVILLAKKU)
The perpetual lamp is a small structure built on the walls which is used for the storage of the church's records.

53 2016-2021

കാലദായാ ചരിതം + മർത്ഥ മറിയം വലിയപള്ളി കോംപ്ലക്സ് തൃശ്ശൂർ

Kaldaya charitham
DOCUMENTATION OF MARTH MARIAM VALIYAPALLI COMPLEX THRISSUR



thank you.



snehajames0055@gmail.com
8921331839